

CONTENTS

ON CONSIGNMENT OF THE MACHINE	6
SERIAL NUMBER PLATE	6
INTRODUCTORY COMMENT	6
INTENDED USE	6
TECHNICAL DESCRIPTION	6
WARNINGS	7
CAUTIONS	7
COMPONENTS	8
OPERATING INSTRUCTIONS	9
ENVIRONMENTAL PROTECTION	11
WIRING DIAGRAM	11
EC DECLARATION OF CONFORMITY	12

On consignment of the machine

When the machine is consigned to the customer, an immediate check must be performed to ensure all the material mentioned in the shipping documents has been received, and also to check the machine has not suffered damage during transportation. If this is the case, the carrier must ascertain the extent of the damage at once, informing our customer service office. It is only by prompt action of this type that the missing material can be obtained, and compensation for damage successfully claimed.

Introductory comment

DYNAMIC is a wet and dry vacuum cleaner.

The machine must only be used for this purpose. Even the best machines will only work well if used correctly and kept in good working order. We therefore suggest you read this instruction booklet carefully and read it again whenever difficulties arise while using the machine. If necessary, remember that our customer assistance service (organized in collaboration with our dealers) is always available for advice or direct intervention.

Intended use

This machine is intended for commercial use, for example in hotels, schools, hospitals, factories, shops, offices and rental businesses.

The machine is not suitable for use in the rain, or under water jets. It is **FORBIDDEN** to use the machine for picking up dangerous dusts or inflammable liquids within places with a potentially explosive atmosphere. In addition, it is not suitable as a means of transport for people or objects.

Serial number plate

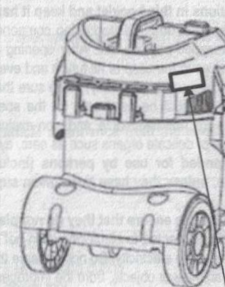

Technical description	UM	DYNAMIC 20	DYNAMIC 30	DYNAMIC 20A	DYNAMIC 30A	DYNAMIC 30AS	DYNAMIC 40AM*
Voltage	V	220 - 240	220 - 240	220 - 240	220 - 240	220 - 240	220 - 240
Frequency	Hz	50/60	50/60	50/60	50/60	50/60	50/60
Power Nom / Max	W	1150/1300	1150/1300	1150/1300	1150/1300	1150/1300	1150/1300
Vacuum	mbar	225	225	225	225	225	225
Air flow	l/s	50	50	50	50	50	50
Tank	l	20 / 10	30 / 20	20 / 10	30 / 20	30 / 20	40 / 30
Material tank	-	PP	PP	INOX	INOX	INOX	INOX
Cord lenght	m	7	7	7	7	7	7
Weight	kg	11	11	12	12	12	15
Sizes (lxwxh)	mm	440x365x555	440x365x680	440x395x615	440x395x725	440x395x725	500x395x1030
Noise level	dB	73	73	73	73	73	73
Accessories Diam.	mm	35	35	35	35	35	35

A: inox tank
S: with socket
M: with trolley

3000 Ft / max + A FA



WARNINGS



Read carefully the instructions in this booklet and keep it handy for further reference. Failure to observe these warnings

can affect the safety of the vacuum. The packaging components (plastic bags, staples, etc.) can be dangerous and must therefore be kept out of the reach of children and handicapped persons, etc. After opening the package, check to make sure that the vacuum is intact and complete. In case of any irregularity or missing pieces, as in the case of all future and eventual repairs, contact an authorized service center which can guarantee the use of original parts. Before connecting the vacuum to electricity, make sure that the electrical specifications on the technical data label of the unit correspond to those of your electrical outlet. This unit must be used only for the specific purposes for which it has been manufactured, namely: cleaning of inert surfaces, vacuuming of solids which are non-flammable and non-explosive. Any other use must be considered improper and dangerous. Avoid bringing the attachments in close distance of delicate organs such as ears, eyes, mouth, etc.

This appliance is not intended for use by persons (including children) with reduced physical, sensory or mental capabilities, or lack of experience and knowledge, unless they have been given supervision or instruction concerning use of the appliance by a person responsible for their safety.

Children should be supervised to ensure that they do not play with the appliance.

The vacuum must not remain connected to electricity when not in use. Before carrying out any cleaning or maintenance work on the vacuum, make sure that the vacuum is not connected to electricity. Do not immerse the vacuum in water. Do not use any solvents. The manufacturer cannot be held responsible for any damage to persons, animals or objects, from the improper or unreasonable use of this vacuum, or from failure to observe the warnings in this booklet or from the failure to carry out the instructions therein. Do not use the vacuum with the power cord twisted on the cover head. This equipment can be used in several communities, as an example in lodges, schools, hospitals, factories, stores, offices and in residences.

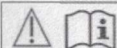

CAUTIONS

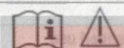

The rules below must be followed carefully to avoid injury to the operator and machine.

CAUTION!

Before starting, read carefully the instructions manual and follow these safety instructions. The plates of danger and of warning on the machine provide important information for safe operation. Apart from the information in the operating instructions, all the general laws of safety and of the preventions of accidents must be followed.

ELECTRIC CONNECTION.

The voltage indicated on the rating plate must correspond to the voltage of the electric source.

Never touch the mains plug with wet hands.

Do not run over, crush or pull the power supply cable or extension lead, otherwise it may be damaged. Protect the cable from heat, oil and sharp edges.

If the supply cord is damaged, it must be replaced by the manufacturer or its service agent or a similarly qualified person in order to avoid a hazard.

Cleaning equipment must not be made directly with a water hose or a high-pressure (danger of short circuits or other damage)

APPLICATION.

Before use, check that the unit and operating equipment, in particular, the power supply cable and the extension lead, are in perfect condition and are safe to operate. Do not use the units if it's not in perfect condition.

Never suck up explosive or combustible gases, liquids or dusts, or undiluted acids and solvents! Substances to avoid also include petrol, paint thinner and fuel oil which could form explosive fumes or mixtures by being in turbulence with the air under suction. In addition, the list includes acetone, undiluted acids and solvents, as well as aluminum and magnesium dusts. These substances can also attack the materials used in the unit.

Do not draw in burning or glowing objects. Do not direct the unit at people or animals.

In case of low temperatures, the unit may not be used.

The appropriate safety regulations must be observed when using the unit in dangerous areas (e.g. petrol stations). It is forbidden to operate the unit in potentially explosive locations.

This machine is suitable collective use, such as hotels, schools, hospitals, industries, shops, offices and residences.

OPERATION.

The operator must use the unit in accordance with the regulations. He/she must take local conditions into consideration and be aware of other people, especially children, when operating the unit.

The unit may only be used by persons who have been instructed in how to use it or who have proved their ability to operate it and who have been expressly commissioned to use it.

The unit may not be operated by children or by the frail and infirm without supervision.

Never leave the unit unattended unless you have switched it off and pulled out the mains power plug.

TRANSPORT.

Switch off the motor and secure the unit before transporting.

MAINTENANCE.

Switch off the unit prior to cleaning and maintenance and before replacing components. Pull out the mains plug if the unit is mains operated. Switch off the unit when changing over to another function.

Repairs may only be carried out by authorized customer service centers or by specialists in this field who are familiar with all relevant safety regulations.

ACCESSORIES AND SPARE PARTS.

Only use accessories and spare parts which have been approved by the manufacturer.

Original accessories and spare parts guarantee that the unit can be operated safely and without any breakdowns.

VACUUM CLEANER.

This unit must not be used for removing dust or liquids which are hazardous to your health unless specifically indicated on the unit.

Comply with the safety information in the operating instructions!

Do not keep the unit in sub-zero temperatures

ATTENTION!

If the feeder cable is damaged, it must be replaced near an authorized center technical attendance from the constructor or in any case by a professional qualified figure, to preview any risk.





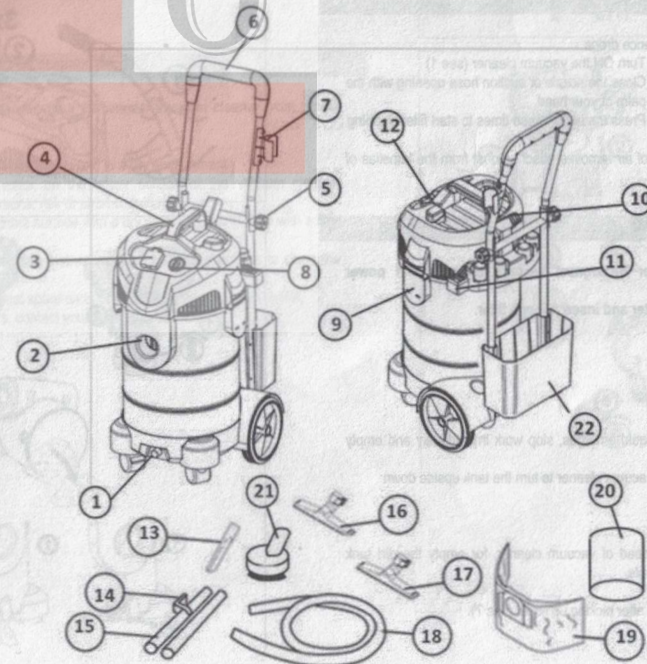

COMPONENTS

1. Drainage nipple
2. Suction inlet
3. Socket for power tool (optional)
4. Carry handle
5. Trolley screws (optional)
6. Trolley handle (optional)
7. Parking function for tube (optional)
8. On/off switch
9. Buckles
10. Hook for cable storage
11. Parking holder for tube on non-trolley versions

12. Filter Cleaning button
13. Crevice tool
14. Parking clip for tube
15. Tubes
16. Floor nozzle
17. Wet nozzle
18. Hose
19. Paper bag
20. Sponge filter
21. Brush
22. Storage box (optional with trolley)



OPERATING INSTRUCTIONS

-  **IMPORTANT:** Always unplug the vacuum cleaner from the electrical outlet before removing the dust bag
-  **IMPORTANT:** DO NOT use the vacuum cleaner without ALL of the filters in place
-  **IMPORTANT:** the accessories are stored in the dust bag compartment and need to be removed before operating the vacuum cleaner
-  **WARNING:** Always switch off and unplug the vacuum cleaner from the electrical outlet before assembling, opening or emptying the dirt container, or before connecting/disconnecting the attachments
-  **CAUTION:** The vacuum cleaner is a very powerful unit. Before plugging the cord into the outlet make sure the switch is in the "off" position. Hold the vacuum cleaner firmly when starting and in use
-  **IMPORTANT:** If the inlet or hose is blocked, switch off the vacuum cleaner and remove blockage(s) before re-starting the vacuum cleaner

1. ON / OFF

Connect the plug to the power supply and to turn the switch to position I

2. Filter cleaning

If the suction performance drops

- a. Turn ON the vacuum cleaner (see 1)
- b. Close the nozzle or suction hose opening with the palm of your hand.
- c. Press the button three times to start filter cleaning

The resulting stream of air removes attached dust from the lamellas of the filter elements.

3. Picking up liquids

Before remove filter disconnect vacuum cleaner from power supply.
Remove cartridge filter and insert sponge filter.

If foam develops or liquid emerges, stop work immediately and empty the dirt tank
Remove the head of vacuum cleaner to turn the tank upside down

Without remove the head of vacuum cleaner, for empty the dirt tank using the drainage nipple.

The filter needs to dry after picking up liquid (see 7).

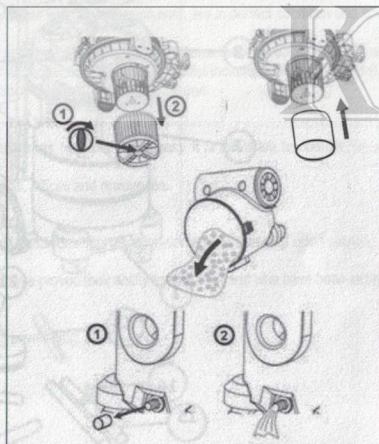
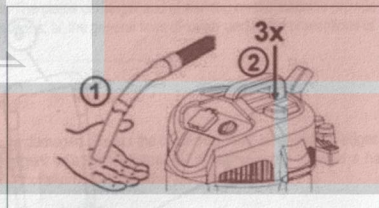
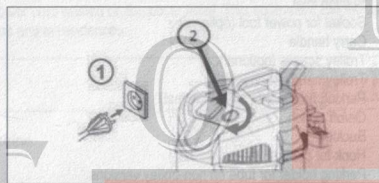

4. Connecting electrical appliances

Before connect power tool check that request power don't exceed what is written on the socket

This section is only valid for models with socket for power tools.
Use the socket on the vacuum cleaner for the purpose defined in the operating instructions only. Before plugging an appliance into the vacuum cleaner socket, switch off the vacuum cleaner and switch off the appliance to be connected.
Follow the operating instructions and safety instructions for appliances connected to the power tool socket.
To switch on the power tool turn the button on 2 position.

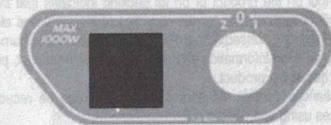

5. Trolley

This section is only valid for models with trolley.
To ease transportation, loosen the 2 trolley screws (7) to bend the handle over.

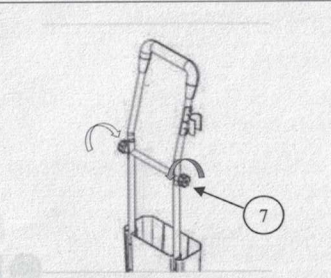

6. Maintenance, cleaning, repair

Before any maintenance disconnect vacuum cleaner from power supply

Store the machine indoors and in a dry environment
Never spray water on the upper section of the vacuum cleaner.
Danger for persons, risk or short-circuiting.
Clean the machine surface with a dry cloth or a damp cloth with a little cleaning agent.
Follow the operating instructions and safety instructions to clean the filter.
Order just original spare parts and accessories from local dealer.
For any repairs, contact your local dealer

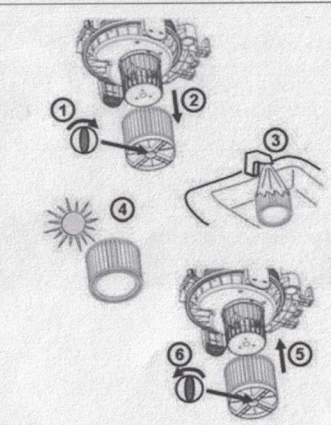



ENVIRONMENTAL PROTECTION



The symbol on the product or on its packing indicates that this product may not be treated as household waste. Instead it shall be handed over to the applicable collection point for the recycling of electrical and electronic equipment. By ensuring this product is disposed of correctly, you will help prevent potential negative consequences for the environment and human health, which could otherwise be caused by inappropriate waste handling of this product. For more detailed information about recycling of this product, please contact your local city office, your household waste disposal service or the shop where you purchased the product.

Old appliances contain valuable materials that can be recycled. Please arrange for the proper recycling of old appliances. Please dispose your old appliances using appropriate collection systems.

Filters and filter bags are made from environment-friendly materials. They can be disposed off through the normal household garbage provided you have not sucked in substances that are not permitted to be thrown into household garbage.

WIRING DIAGRAM

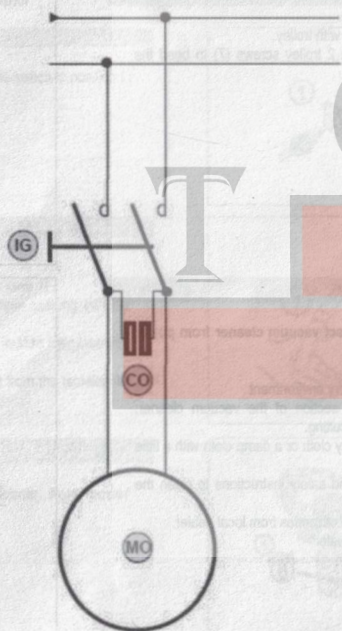

MO = MOTOR
CO = CAPACITOR
IG = TWO POLES SWITCH

DECLARATION OF CONFORMITY

The undersigned manufacturer
TMB s.r.l.
Via C. M. de' S. 2
31057 San Giovanni Lupatoto (VR)
declares under its sole responsibility that the product
WET AND DRY VACUUM CLEANER DYNAMIC

- 2002/95/EC: Low Voltage Directive
- 2004/108/EC: Electromagnetic Compatibility Directive
- 2006/96/EC: EMC Directive
- 2002/95/EC: Low Voltage Directive

They also comply with the following standards:

- EN 60335-1: Household and similar electrical appliances - Safety - Part 1: General requirements
- EN 60335-2-69: Household and similar electrical appliances - Safety - Part 2: Particular requirements for wet vacuum cleaners
- EN 61000-3-2: Electromagnetic compatibility (EMC) - Part 3-2: Limits - Class B for equipment with a rated current ≤ 16 A per phase
- EN 61000-3-3: Electromagnetic compatibility (EMC) - Part 3-3: Limits - Class B for equipment with a rated current > 16 A per phase
- EN 55014-1: Electromagnetic compatibility - Regulations for household appliances, electrical tools and similar equipment - Part 1: Emission - Regulations for product family
- EN 55014-2: Electromagnetic compatibility - Regulations for household appliances, electrical tools and similar equipment - Part 2: Immunity - Regulations for product family
- EN 62323: Household and similar electrical appliances - Electromagnetic compatibility - Regulations for product family

The person authorized to compile the technical file:

Sig. Giovanni Ruffa
Via C. M. de' S. 2
31057 San Giovanni Lupatoto (VR) - ITALY
San Giovanni Lupatoto: 0445/25013

TMB s.r.l.
Via C. M. de' S. 2
31057 San Giovanni Lupatoto (VR) - ITALY
Tel: +39 045 8711589 Fax: +39 045 8711545 E-mail: tmb@tmb.it

TMB s.r.l.
Via C. M. de' S. 2
31057 San Giovanni Lupatoto (VR) - ITALY
Tel: +39 045 8711589 Fax: +39 045 8711545 E-mail: tmb@tmb.it

EC DECLARATION OF CONFORMITY

The undersigned manufacturer:

TMB s.r.l.
Via Ca' Nova Zampieri, 5
37057 San Giovanni Lupatoto (VR)

declares under its sole responsibility that the products

WET AND DRY VACUUM CLEANER DYNAMIC

comply with the requirements of the following Directives:

- 2006/42/EC: Machinery Directive
- 2006/95/EC: Low Voltage Directive
- 2004/108/EC: Electromagnetic Compatibility Directive
- 2011/65/UE (RoHS)

They also comply with the following standards:

- EN 60335-1: Household and similar electrical appliances - Safety. Part 1: General regulations
- EN 60335-2-69: Household and similar electrical appliances - Safety Part 2: Particular requirements for wet and dry vacuum cleaners, including power brush, for industrial and commercial use
- EN 61000-3-2: Electromagnetic compatibility (EMC) - Part 3-2: Limits - Limits for harmonic current emissions (Equipment with input current ≤ 16 A per phase).
- EN 61000-3-3: Electromagnetic compatibility (EMC) - Part 3-3: Limits - Restriction of voltage variations and flicker in low voltage power supply systems for devices with a rated current ≤ 16 A.
- EN 55014-1: Electromagnetic compatibility - Regulations for household appliances, electrical devices and similar equipment. Part 1: Emission - Regulation for product family.
- EN 55014-2: Electromagnetic compatibility - Regulations for household appliances, electrical devices and similar equipment. Part 2: Immunity - Regulation for product family.
- EN 62233: Household and similar electrical appliances - Electromagnetic fields Methods for evaluation and measurement

The person authorized to compile the technical file:

Sig. Giancarlo Ruffo
Via Ca' Nova Zampieri, 5
37057 San Giovanni Lupatoto (VR) - ITALY

San Giovanni Lupatoto, 03/05/2013

TMB s.r.l.
Il Legale Rappresentante
Giancarlo Ruffo

TMB s.r.l.
Via Ca' Nova Zampieri
37057 San Giovanni Lupatoto (VR) Italy
Tel. +39 045 8774299 r.a. - Fax +39 045 8774245 - E-mail: tmb@tmbvac.it - www.tmbvacuum.com

USE AND MAINTENANCE MANUAL

152.522, 523, 524



DYNAMIC

ED. 05-2013

EN

ORIGINAL
INSTRUCTIONS
Doc. 10041304
Ver. AA

